

Features and benefits

- 18 channels for direct insertion of POF leads
- 4 sensors per channel: RGB and clear
- Programmable analog gain and digital signals processing
- 1M: 1 dynamic range
- USB 2.0 interface
- Powered via USB interface
- LabView user interface
- LED emitter (RGB) for board calibration
- ITA connector VPC 510 108 115

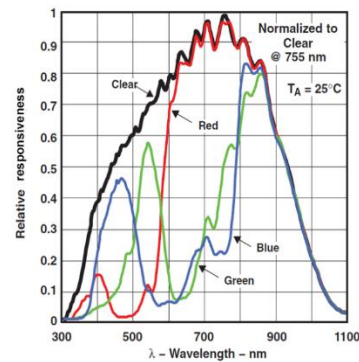

Simple and effective solution for colour analysis

The format of the AL568 optical fibre for LED test is the most convenient and effective system on the market. It **sists** in the space of a 90 Series VPC module and only requires connection to a USB port to get data from up to 18 LEDs.

It has a RGB light emission channel suitable to perform calibration checks.

Parameter	Test Conditions	Red Channel		Green Channel		Blue Channel		Clear Channel			Unit
		Min	Max	Min	Max	Min	Max	Min	Typ	Max	
R_e Irradiance responsiveness	$\lambda_D = 465 \text{ nm}^{(2)}$	0%	15%	10%	42%	65%	88%	19.2	24	28.8	counts/ ($\mu\text{W}/\text{cm}^2$)
	$\lambda_D = 525 \text{ nm}^{(3)}$	8%	25%	60%	85%	9%	35%	22.4	28	33.6	
	$\lambda_D = 625 \text{ nm}^{(4)}$	85%	110%	0%	15%	5%	25%	27.2	34	40.8	

Order information

Part Number	Supply contents
AL568	18-Channels RGB optical fibre LED analyser with USB Interface <ul style="list-style-type: none"> Includes USB Cable (1m)
VP510108115	ITA Module

Accessories and spare parts

Part Number	Supply contents
AN394	POF D=1,5 mm probe 600 mm length with ITA clamps
AN458	POF D=1,5 mm probe 600 mm length with ITA clamps
YAV90CLR10	POF D=5 mm aspherical lens head probe 600 mm length
YAV90CLR11	POF D=1,5 mm aspherical lens head probe 600 mm length
AA503	Optical fibre extraction tool
AN395	POF ITA D=POF 1,5 mm contact for VPC 510108115
AN396	POF RCV D=POF 1,5 mm contact for VPC 510104123

Connection diagram

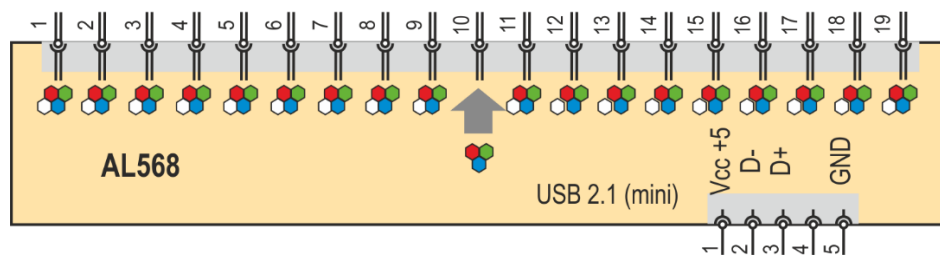

Application examples

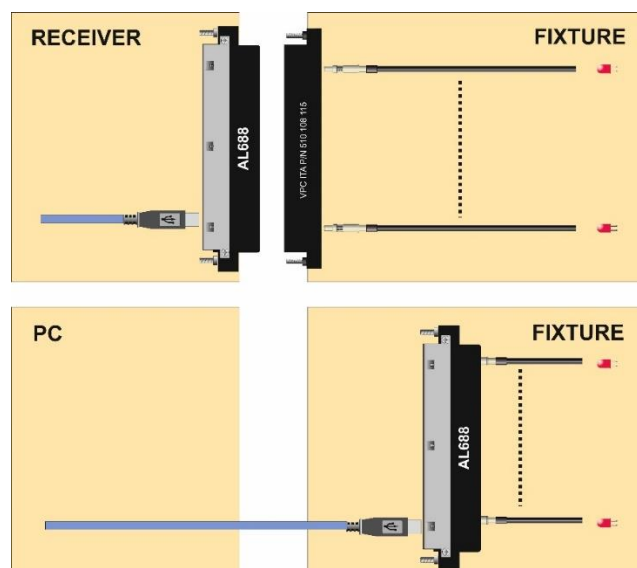

Specifications

Characteristics	Item	Specifications
YAV board	Application	LED analyzer
	Number of channels	18
	Calibration emitter channel	1 x RGB
	RCV connector	VPC 510 104 123
	Control	USB 2.1
	Power required	5VDC +5% I Max 100mA from USB connector
Conditions	Conditions for operation, transport and storage	Environment temperature: -40°C to +85 Moisture sensitive level 3

Dimensions

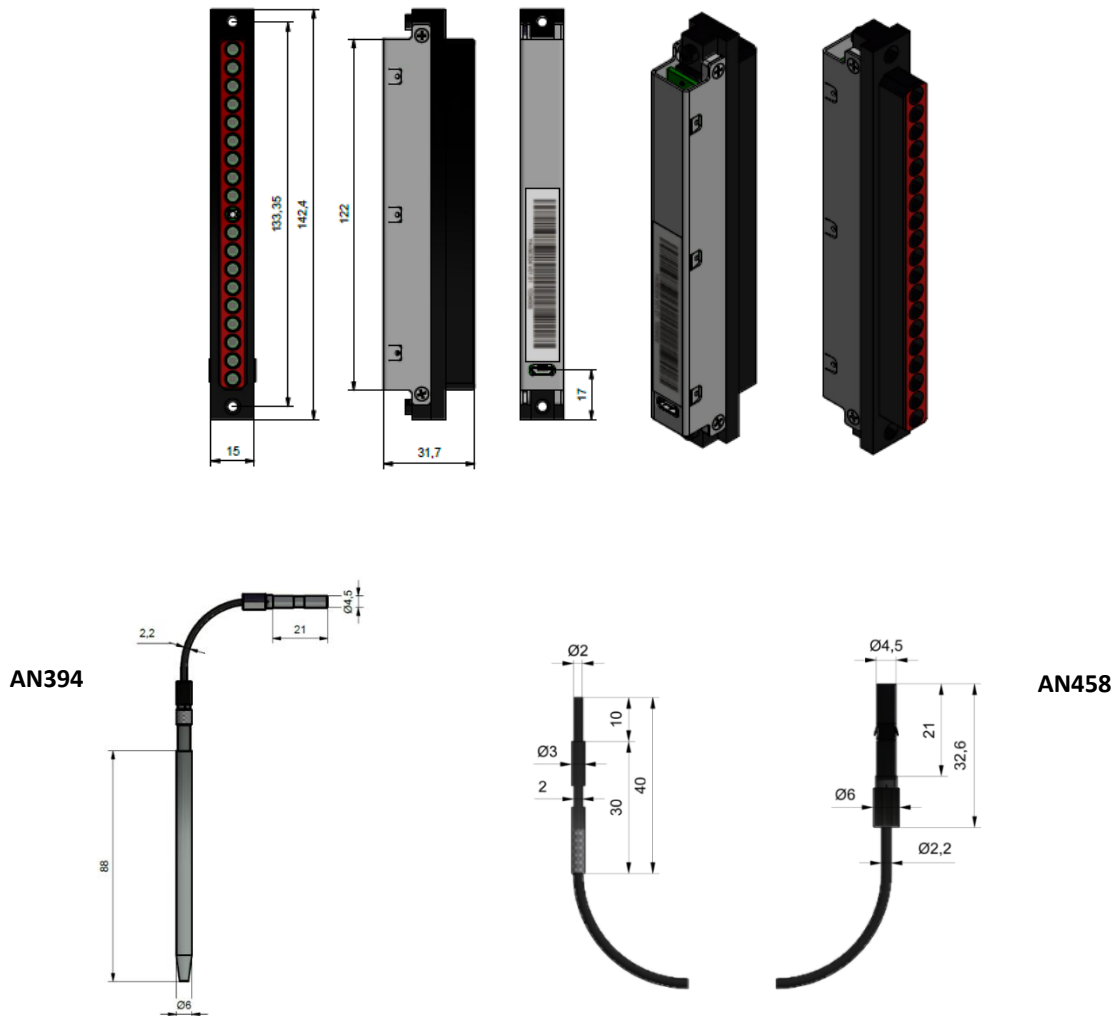

YAV90CLR10

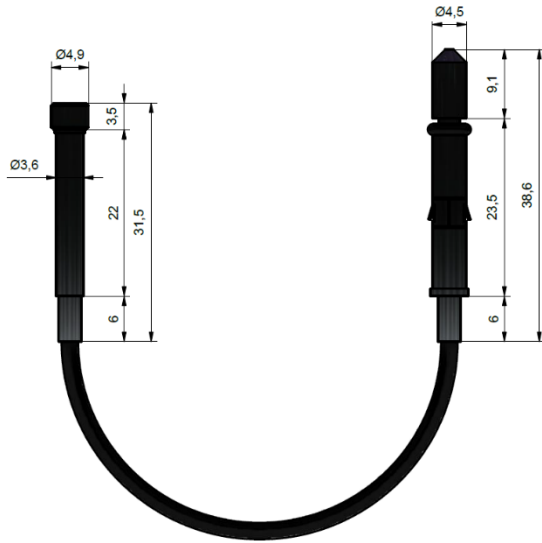

YAV90CLR11

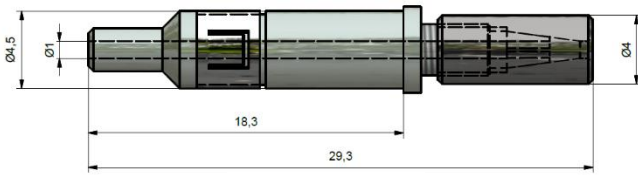
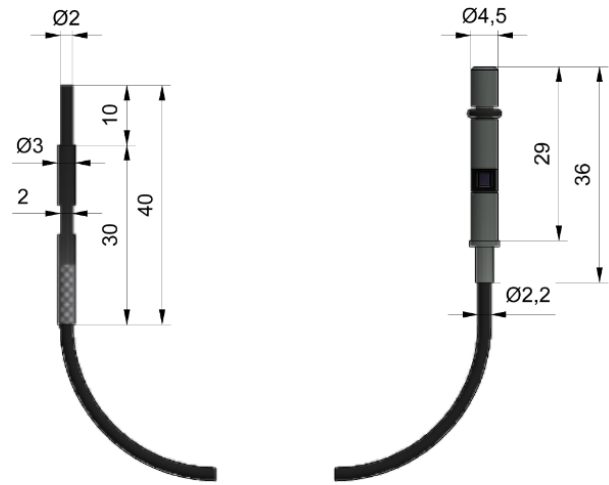

AN395

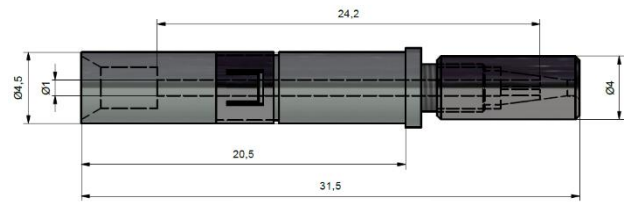

AN396

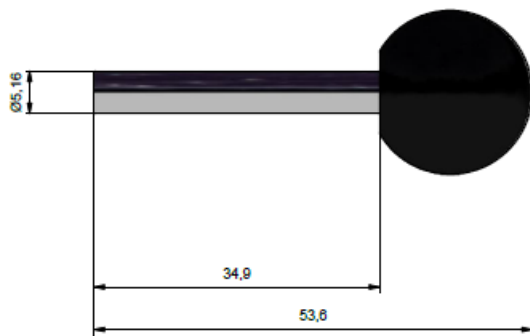

AA503

